

Table of Contents

- | [Property Details](#)
- | [Location](#)
- | [Pricing Information](#)
- | [Neighbouring Suburbs](#)
- | [Key Documents](#)
- | [Your Local Agents](#)
- | [Helpful Links](#)
- | [Ranges First National - About Us](#)

Property Details



4/2-4 Sophia Grove, Tecoma

OVER 55'S UNIT IN A CONVENIENT, QUIET LOCATION

UNDER CONTRACT

\$565,000

Perfectly located within an easy stroll to Tecoma's shopping village and public transport, this well-maintained, two-bedroom over 55's lifestyle unit comes complete with views of the nearby Ranges and is without doubt, certainly one of the best in the area.

Nestled in a unit complex of only four lovely, well-kept units, this much-loved home has a spacious kitchen with gas cooking, a main bathroom and a good-sized laundry/utility room. Solar panels have also been added to keep electricity costs to a minimum!

The north-facing, sun-filled lounge room sits adjacent to the dining/meals area and creates an open plan design which is perfect for day-to-day living and includes a reverse cycle split system that has been added to keep your temperature under control all year round. The beautiful backdrop of the nearby hills awaits from your front window, and you can take it in while enjoying an afternoon cuppa on your front deck. Outside, the rear courtyard is designed for very low maintenance while a single remote garage is now a hobby/workshop and store room plus extra parking bay.

We all know that units in the Dandenong Ranges are very hard to come by, so it will be snapped up quickly - Contact us today for your chance to secure one of Tecoma's best units.

Contact

GRANT SKIPSEY

0418528120

<https://www.consumer.vic.gov.au/duediligencechecklist>

Please note: All property details listed were current at the time of publishing.

[Statement of Information](#)







4/2-4 Sophia Grove TECOMA

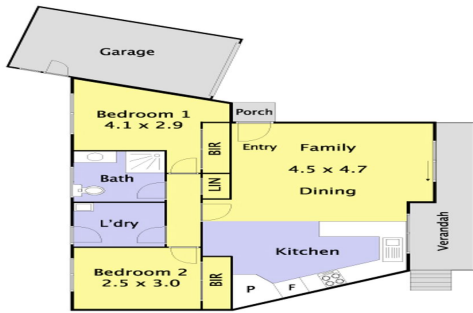

approx. 944.84m² (including verandah)
 While every precaution has been taken to verify this information, it does not constitute any representation by the agent or vendor.

Location

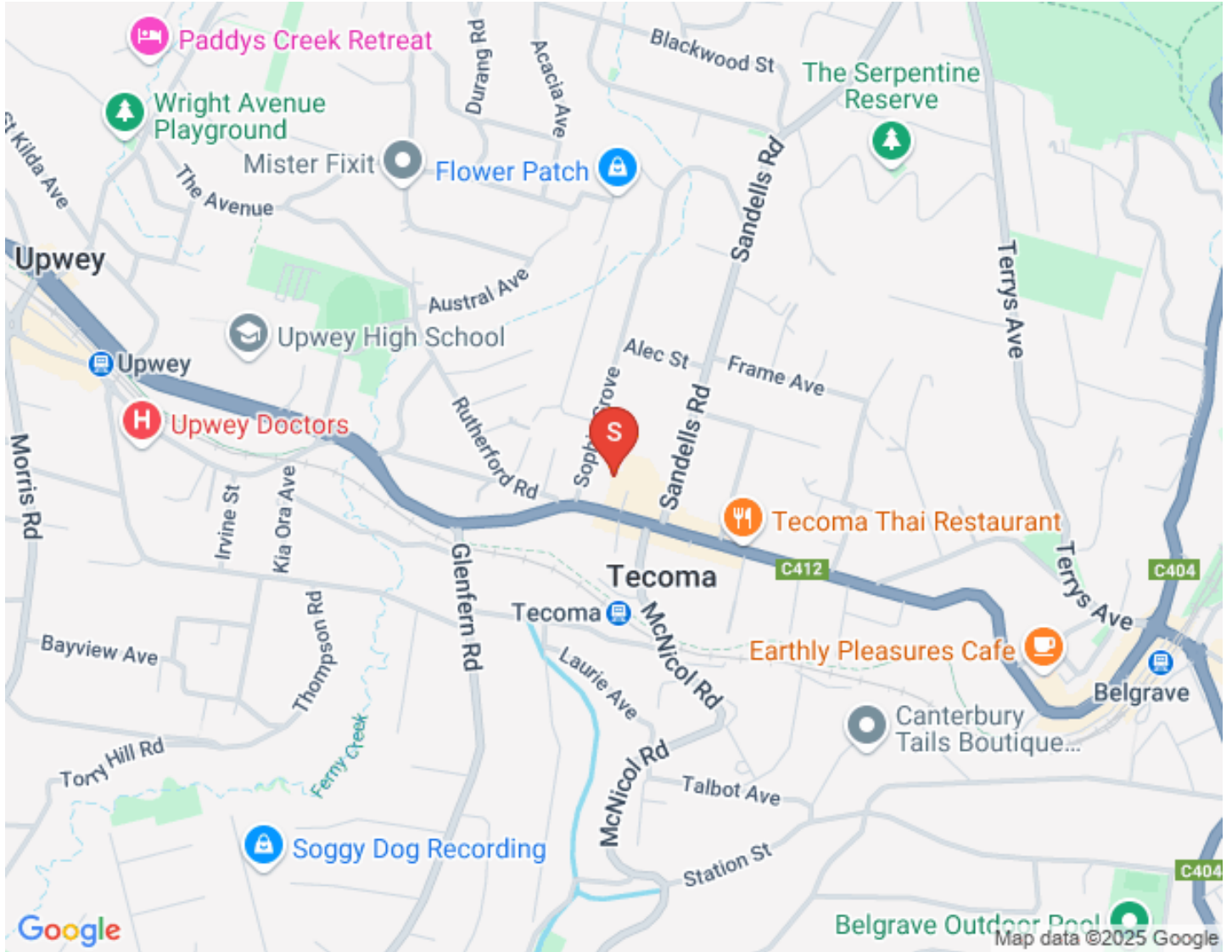

Pricing Information

The property at 4/2-4 Sophia Grove, Tecoma is currently for sale at **UNDER CONTRACT \$565,000 - \$625,000.**

Click here to view the [Statement of Information](#)

Neighbouring Suburbs

Belgrave

A Character Of Its Own



Belgrave



Belgrave South

Just a Little South - Click here to find out more about the

- [Belgrave South Suburb Profile](#)



Belgrave South



Cockatoo

A Better Place to Live - Click here to find out more about the

- [Cockatoo Suburb Profile](#)



Cockatoo



Emerald

Get the life you're Looking for - Click here to find out more about the - [Emerald Suburb Profile](#)



Emerald



Ferny Creek

Surrounded by Nature - Click here to find out more about the

- [Ferny Creek Suburb Profile](#)



Ferny Creek

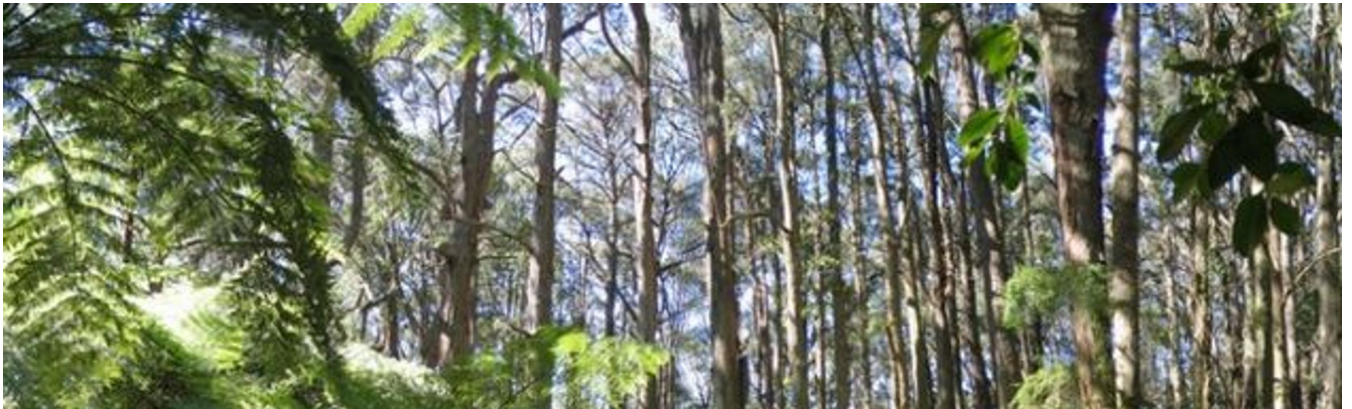

Gembrook

A Destination that Matters - Click here to find out more about the - [Gembrook Suburb Profile](#)



Gembrook

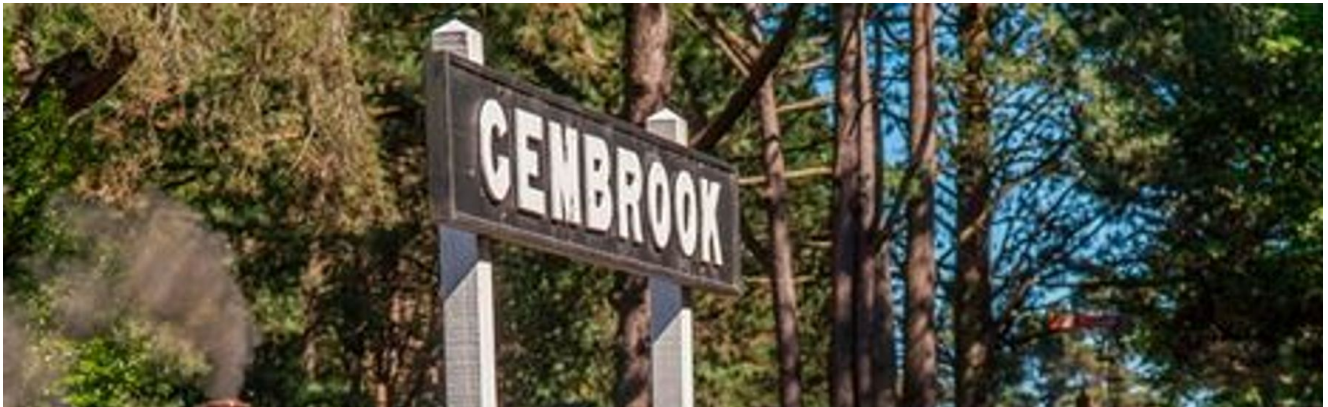

Kallista

Tourisim Village - Click here to find out more about the - [Kallista](#)

[Suburb Profile](#)



Kallista



Macclesfield

Horse Lovers Paradise - Click here to find out more about the

- [Macclesfield Suburb Profile](#)



Macclesfield



Menzies Creek

Leafy Green - Click here to find out more about the - [Menzies Creek](#)

[Suburb Profile](#)



Menzies Creek



Monbulk

Hiding Place In The Hills - Click here to find out more about the - [Monbulk Suburb Profile](#)



Monbulk



Olinda

Charming Village - Click here to find out more about the [Olinda](#)

[Suburb Profile](#)



Olinda

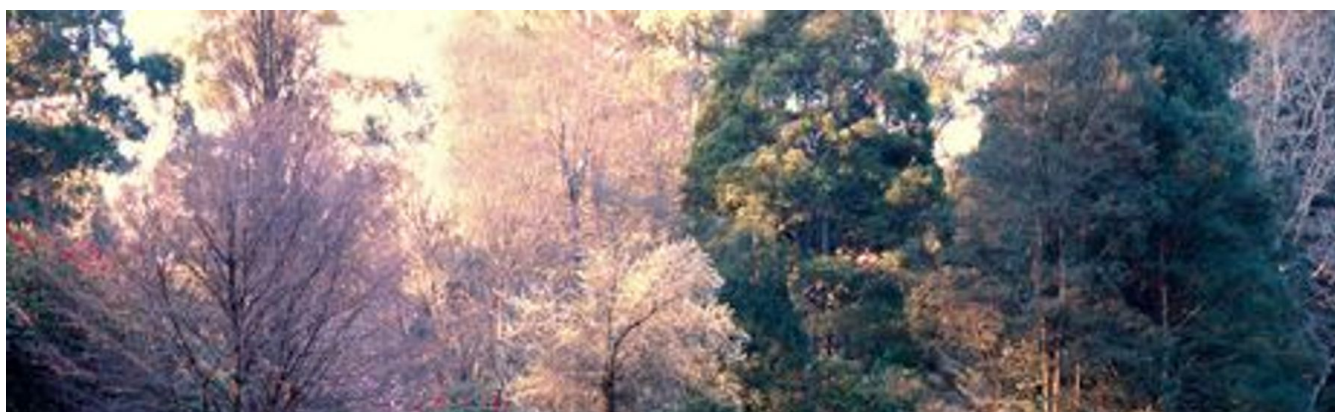

Sassafras

Devonshire Teas And More - Click here to find out more about
the - [Sassafras Suburb Profile](#)



Sassafras



Selby

A Place To Belong - Click here to find out more about the [Selby](#)

[Suburb Profile](#)



Selby



Tecoma

Don't Miss It! - Click here to find out more about the [Tecoma](#)

[Suburb Profile](#)



Tecoma



The Patch

Small but Scenic - Click here to find out more about the - [The Patch Suburb Profile](#)



The Patch



Upwey

Engage Upwey's Favourite - Click here to find out more about
the - [Upwey Suburb Profile](#)



Upwey

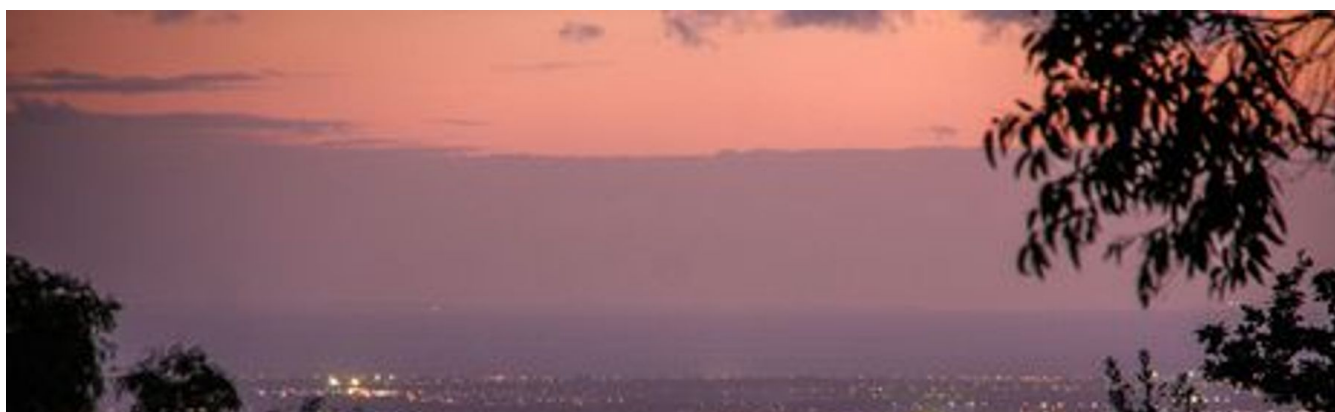

Key Documents

[Download the Due Diligence Checklist](#)

Your Local Agents



GRANT SKIPSEY

SENIOR SALES CONSULTANT

0418 528 102

grants@rangesfn.com.au

Grant has been valuing the local market for over half his life and has not only survived but also thrived with the innovations that have occurred during his 40 years working and living in the local area.

“There have been more changes in our office in the last 5 years than in the previous 30 combined. Each new concept is designed to improve the customer service and results for our clients. I am still amazed at how much more we do today compared to years gone past. Change in Real Estate is inevitable. Growth is optional. It’s a great feeling being a part of the most progressive company in the area.”

Grant received a Gold Sales Award for the 2018, 2019, 2020 & 2022 Gem Awards. This is an outstanding achievement and takes a lot of hard work and persistence to receive such a prestigious award.

Helpful Links



Links

[Home Buyer Guide](#)

[Recent Sales](#)

[New Properties](#)

[Multiple offer form](#)

[Local Property Guide](#)

Ranges First National - About Us

Thank you for viewing the E-Book for 4/2-4 Sophia Grove Tecoma, if you would like further information or would like to view this property, please call Grant Skipsey on 0418 528 102.



Welcome to First National Real Estate Ranges

We're dedicated to delivering an exceptional experience from our Belgrave & Cockatoo office's, so every member of our team strives to make a difference. That begins with our promise – ***We put you first.***

When you need real estate services, it's hard to beat a brand that has been independently endorsed as having Australia's most satisfied customers but that's us, so relax.

To find out which real estate agents rate most highly across Australia, Canstar Blue surveyed adults who had employed an agent over the last three years, whether it related to the buying or selling of a property, lease management, or renting. It found First National Real Estate has been impressing more than any other firm, taking out five-star reviews from consumers in almost every single category, including communication and advice, problem resolution and value for money. In fact, no other real estate agent achieved top marks in any area.

So, whether you're looking to rent, buy or sell a property in Avonsleigh, Belgrave, Belgrave Heights, Belgrave South, Clematis, Cockatoo, Emerald, Ferny Creek, Gembrook, Kallista, Macclesfield, Menzies Creek, Monbulk, Olinda, Tecoma, The Patch, Selby, Sassafra, Sherbooke and Upwey our team will help you find the perfect place.

Visit the First National Real Estate Ranges Team at one of the two office locations or call us, 03 9754 6111 or email sales@rangesfn.com.au.

We put you first.

Regards,

The Team at First National Ranges - Belgrave & Cockatoo

